

GAS DETECTOR WITH SIGNAL CONVERTER **SD-1RI (ATEX - IECEx) SPECIFICATION**

Model	SD-1RI
Detection principle	Non-dispersive infrared absorption method
Detection gas* ¹	Combustible gas
Concentration display	LED(4digits・7segments)
Detection range* ¹	Depend on Detection gas
Resolution	Depend on Detection gas
Detection method	Diffusion method
Alarm setpoint* ¹	Depend on Detection gas
Power display	POWER lamp lighting(green)
External Output* ¹	Gas concentration signal Alarm contact(Gas alarm or Fault alarm or Gas・Fault common alarm)
Indicate accuracy (under an identical condition)	Within $\pm 5\%$ FS(Repeatability : Within $\pm 2\%$ FS)
Response time (under an identical condition)	Within 60sec(T90)
Gas alarm type	Single alarm(H)
Gas alarm display	ALM lamp lighting(red)
Gas alarm pattern	Auto-recover
Fault alarm・Self diagnosis	System failure(E-9)/Sensor failure(E-1)
Fault alarm display	FAULT lamp lighting(yellow)/content display
Fault alarm pattern	Auto-recover
Alarm contact* ¹	No-voltage contact 1a・Non-exciting at normal(exciting at alarm) or exciting at normal(non-exciting at alarm)
Contact capacity	250VAC・0.5A/30VDC・0.5A(resistive load)
Transmission scheme	Three-wire analog transmission (in common with power supply<power supply, signal, common>)
Transmission specification	4 - 20mADC(linear・load resistance under 300 Ω)
Transmission cable	CVVS 1.25mm ² or 2.0mm ² - 3-core(when the contact is not used) CVVS 1.25mm ² or 2.0mm ² - 5-core(when the contact is used)
Transmission distance	1.25km or less in case of CVVS 1.25mm ² 2.0km or less in case of CVVS 2.0mm ²
Functions	Alarm delay/Suppress
Power supply	24VDC $\pm 10\%$
Power consumption	MAX. 2W
Cabling port* ¹	Adapter A<NPT1/2> or adapter B<NPT3/4> or adapter<M20 \times 1.5> or Pressure proof packing gland <G3/4> (Compatible cables ϕ 9.6 - 13.0mm in outer diameter)
Initial clear	Approx. 25sec
Operating temperature range* ²	-20 - +60 $^{\circ}$ C(non-rapidly-vary)
Operating humidity range	Below 95%RH(non-condensing)
Structure	Wall mounting type
Explosion-proof structure	Flame proof structure
Explosion-proof grade	II 2G Ex db IIC T6 Gb(ATEX) / Ex db IIC T6 Gb(IECEx)
Explosion-proof approval No.	Presafe 20 ATEX 63097X(ATEX) / IECEx PRE 20.0069X(IECEx)
Dimension	Approx. 148(W) \times 149(H) \times 88(D)mm(projection portions excluded)
Weight	Approx. 2.0kg
Color	Munsell 7.5BG5/2

*1 Please specify your request when ordering.

*2 The ambient temperature range which maintain a capability of explosion proof of the label on the detector is -20 \sim +60 $^{\circ}$ C.
However, the available operating temperature range is different depending on detectable gas.

Outline Drawings
【Adapter A<NPT1/2>】

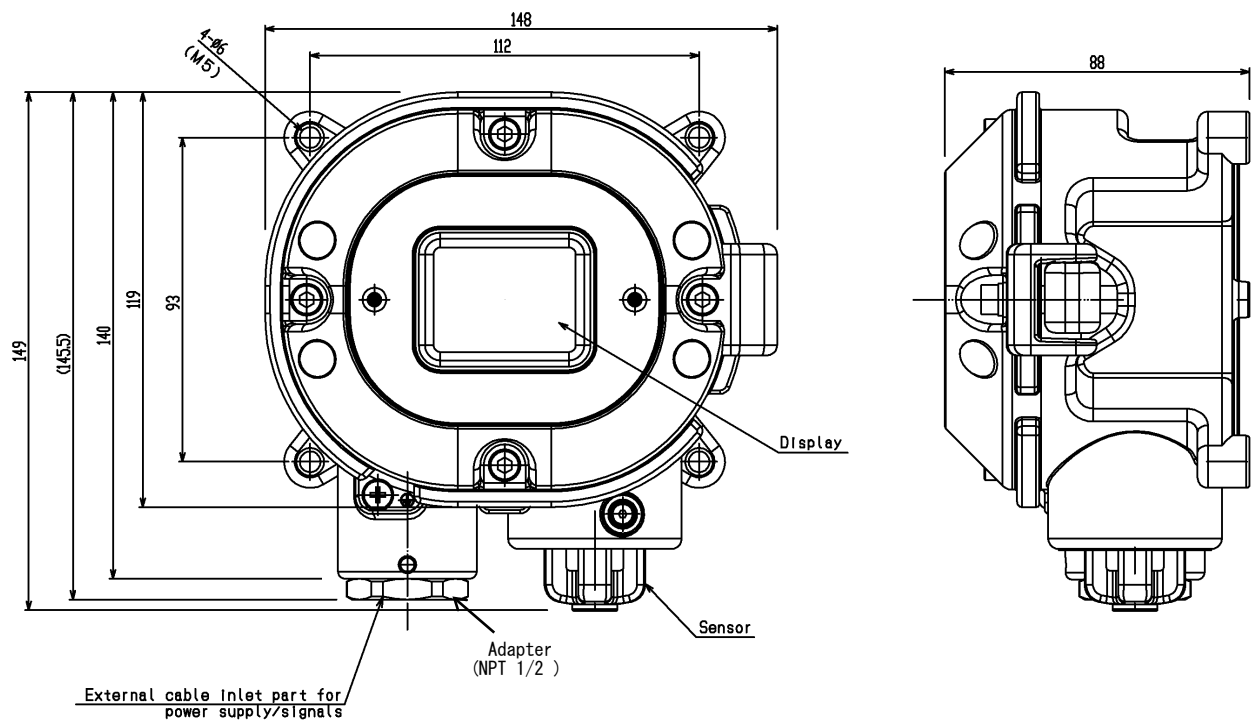

Terminal Drawings

DC24V	DC+	1
	- (common)	2
4-20mA	Sig+	3
	Alarm contact	4
	Alarm contact	5